

## Causes and procedure for alarm/signal notifications



How to deactivate the audio signal:

Signal cause	Signal sounds	Optical signal	Signal deactivation	Solution option
<b>Smoke was recognised:</b> also in case of false alarm, e.g. from steam, kitchen vapours, high dust levels, etc.	<b>Loud alarm</b>	<b>The red LED flashes once every 2 seconds.</b>	<b>Press the user key.</b> The loud alarm sound is deactivated for 15 min. <b>The red LED continues to flash</b> as long as smoke is detected.	<b>Eliminate the cause</b> (stop smoke development, ventilate, ...). If the cause still exists after a further 15 min., a further acoustic alarm is emitted.
<b>Disassembly</b> The smoke detector has been disassembled for at least 21 days.	<b>2 short and quiet audio signals every 10 minutes</b>	<b>The red LED flashes twice every 30 seconds.</b>	<b>Press the user key.</b> The <b>audio signal</b> is deactivated the first 3 times for 7 days, then only respectively for one day. <b>The red LED continues to flash.</b>	Return the device to its original location. The smoke detector carries out a <b>self-test</b> automatically (see reverse side or below).
<b>Item, soiling and cover recognition.</b> An item was established in the surroundings up to 60 cm or the smoke penetration openings are soiled or covered.	<b>2 short and quiet audio signals every 10 minutes</b>	<b>The red LED flashes twice every 30 seconds.</b>	<b>Press the user key.</b> The <b>audio signal</b> is deactivated the first 3 times for 7 days, then only respectively for one day. <b>The red LED continues to flash.</b>	Remove item/cover and trigger/carry out <b>self-test</b> (see reverse side or below). If the smoke penetration opening is soiled and cannot be cleaned: <b>call the hotline (if possible from the apartment affected).</b>
<b>The smoke detector is faulty.</b>	<b>3 times a short and quiet audio signal every 5 minutes</b>	<b>The red LED flashes once every 5 seconds.</b>	<b>Press the user key.</b> The <b>audio signal</b> is deactivated the first 3 times for 7 days, then only respectively for one day. <b>The red LED continues to flash.</b>	<b>Call the hotline (if possible from the apartment affected):</b> <b>+49 (0) 800 2001264 (free of charge)</b>

## Trigger self-test

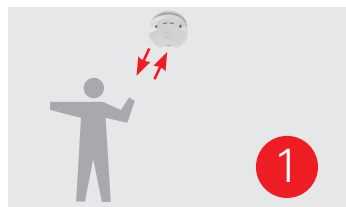

Remove the smoke detector from the base plate for at least 1 min. and then install it back again on the base plate.

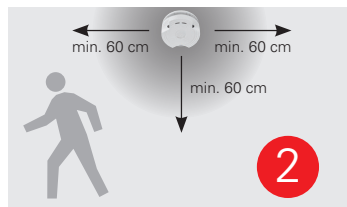

Move **at least 60 cm** away from the vicinity of the smoke detector within **10 seconds**.

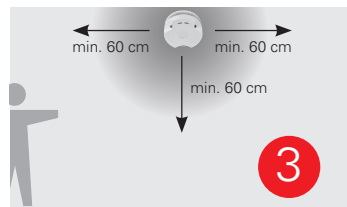

**Wait** at least 30 sec. The smoke detector carries out a self-test and flashes twice per sec. If no signal is emitted, the smoke detector is functional.

## Manual testing

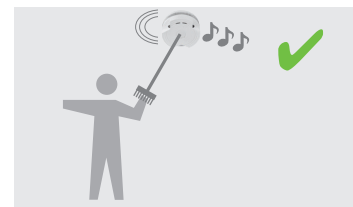

Press the user key for approx. **5 seconds**. If the quiet audio signal sounds (1 sec. on/1 sec. off), the **smoke detector is in working order**. If not, call the free **hotline** as soon as possible: **+49 (0) 8002 001264**.

## Disassembly/re-assembly information

### e. g. for maintenance work

As the smoke detector is equipped with disassembly recognition, it should be re-assembled within 21 days. If a detector is removed from the base plate for longer than 21 days, this will be signalled. You can see how to temporarily deactivate signalling in the table **under "Disassembly"**.

1. Turn the smoke detector anticlockwise manually (to the left) and pull it downwards off the assembly plate.

**(Do not remove the assembly plate!)**

2. If you are disassembling several detectors, note the room from which they come on the reverse side of the detector and on the assembly plate (e.g. L for lounge).

If several detectors are in one room, number them sequentially (e.g. L1, L2 ...).

3. After renovation, install the detector back in its **original room** on its **original assembly plate**, otherwise signalling may be incurred. Observe your **markings** or the **serial number** on the assembly plate and on the reverse of the detector.

4. For assembly, insert the detector/s into the assembly plate and turn them clockwise (to the right) until they/it engage/s.

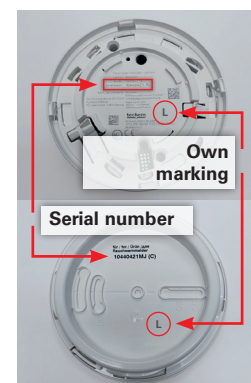

DE ES FR BG RU PL TR AR

www.techem.de/leistungen/rauchwarnmelder



Should you not manage to rectify the cause of the malfunction, please refer to the **Techem hotline** as soon as possible: **+49 (0) 8002 001264** (free and available 24 /7). If possible, call from the apartment affected.